

**5 YEAR
WARRANTY**



POWERED BY

SYNAPSE

Project:

Prepared by:

Type:

Date:

150W (20,250 lm)
200W (27,000 lm)
240W (32,000 lm)
300W (40,500 lm)
400W (52,000 lm)
500W (66,198 lm)

ORDERING INFORMATION

Sample SKU: CHB-P-300W-50K-WD-U-D-B

Series	Wattage	CCT	Beam Angle	Input Voltage	Dimming	Finish	Mounting
CHB-P			WD				
CHB-P	150W 200W 240W 300W 400W 500W	40K - 4000K 50K - 5000K 57K - 5700K	WD - 120°	U - 100-277VAC H - 277-480VAC	D - 1-10V Dimming	W - White	HM - Hanging Mount PM - 3/4" Stem Pendant Mount Kit SM - Surface Mount Kit
Control Options				Accessories		Distribution Options	
M - Bi-level Occupancy/Daylight Harvesting Sensor R - SYNAPSE Wireless Control System				See accessories page		See accessories page	

*MOQ and longer lead times may apply, please contact customer service for more information.

TECHNICAL SPECIFICATIONS

CONSTRUCTION

IP/Enclosure Rating:

IP65/IK10 Impact

Operating Temperature:

-40°F~131°F

Housing:

- Die-cast aluminum (150W~300W)
- Cold-forged aluminum (400W/500W)

Optics:

- 120°/90°/60° (150W~300W Optics)
- 120°/90°/45° (400W/500W Optics)

Power Cord:

- 16/3, 6' SJOW (300V) - 100-277VAC
- 14/3, 6' SOW (600V) -240-480VAC

Finish

- White (Standard)

ELECTRICAL

Input Voltage:

- 100-277VAC
- 277-480VAC

THD:

<20%

Power Factor:

>0.95

Surge Protection:

- 6kV (Standard)/10kV (Optional) [150W~300W]
- 10kV (Standard)/20kV (Optional) [400W/500W]

Emergency Battery Backup

60W Emergency Inverter (For 150W~300W, Field Install)

CONTROLS/DIMMING

- 1-10V Dimming
- Bi-level Occupancy/Daylight Harvesting Motion Sensor
- SYNAPSE Wireless Control System

REFLECTORS

Distribution:

- 90° PC Reflector with Lens (150W~500W)
- 70° PC Reflector with Lens (400W/500W)

CRI:

CRI >80 (Standard)

Available CCT:

4000K, 5000K, 5700K

Projected L70:

>100,000 hrs

INSTALLATION/MOUNTING

- Hanging Mount (Standard)
- Surface Mount Kit
- Pendant Mount Kit (3/4") [Stem not included]

WARRANTY

5 Year Warranty
7/10 Year Warranty Available
See warranty documentation for more information.

PERFORMANCE DATA

Wattage	150W	200W	240W	300W	400W	500W
Delivered Lumens	20500 lm	27000 lm	31200 lm	39000 lm	52000 lm	66198 lm
System Efficacy	135lm/W	135 lm/W	130 lm/W	130 lm/W	129 lm/W	130 lm/W

Typical delivered lumen data is approximate. Actual lumens may vary due to installation environment and Distribution. Please See IES Files

DISTRIBUTION

*IESNA LM-63 IES Available upon request

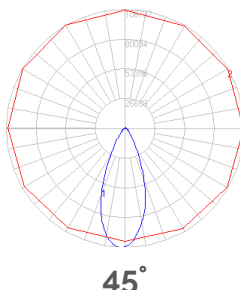
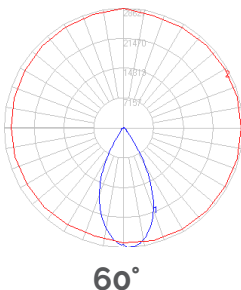
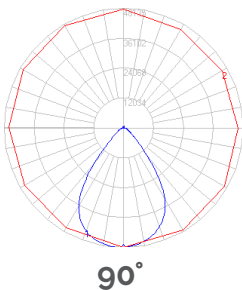
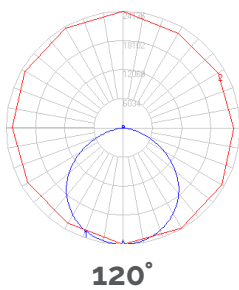

DIMENSIONS

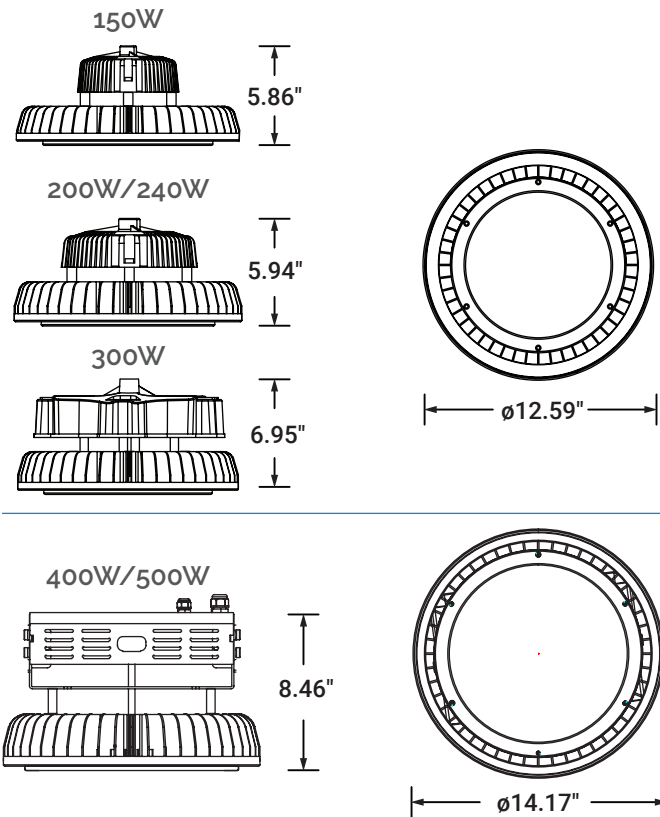

ELECTRICAL LOAD

Wattage (W)	Input Voltage					
	120V	208V	240V	277V	347V	480V
	Current (A)					
150	1.31	0.76	0.63	0.57	0.91	0.45
200	1.67	1.01	0.88	0.76	0.61	0.44
240	2.10	1.21	1.05	0.91	0.73	0.53
300	2.63	1.51	1.31	1.14	0.91	0.66
400	3.50	2.02	1.75	1.52	1.21	0.88
500	4.38	2.52	2.19	1.90	1.51	1.09

WEIGHT (lbs)

Wattage (W)	Weight
150	10
200	12
240	12
300	14
400	18
500	18

ACCESSORIES



Safety Chain &
Hanging Hook
[Included]



Surface Mount
Bracket [SM]

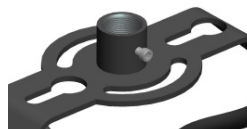

3/4" Thread
Pendant Mount
(Stem Not Included)
[PM]



60W Emergency Inverter
[Field Install]
(Available For 150W~300W)
(100-347V)
[TGS-60W-HB-INT]



PC Reflectors 16" dia.
(Available in 60°)
[CHB-P-PN]



PC Reflectors 16" dia.
(Available in 90°)
[CHB-P-PM]



PC Reflectors 22" dia.
(Available in 70°)
[CHB-P-HP-PN-22]



PC Reflectors Lens Cover
[CHB-P-LC]
[CHB-P-HP-LC]



Bi-level Occupancy/
Daylight Harvesting
Sensor
[M]



NEMA Twist
Lock Plug
[L7-15]
[L7-20]

Accessories

L7-15 (NEMA Twist Lock Plug [120-277V, 15Amp])
L7-20 (NEMA Twist Lock Plug [120-277V, 20Amp])
CHB-P-SP (10kV Surge Protector) [150W~300W]
CHB-P-HP-SP (20kV Surge Protection) [400W/500W]
SAFETY-SS-10FT (10' Safety Cable)
TGS-60W-HB-INT (60W Emergency Inverter [120-347V] [150W-300W]
[Factory Install])

Distribution Options

CHB-P-PM -16 (PC 90° Reflector) [150W/200W/240W/300W]
CHB-P-LC (PC Reflector Lens Cover)
CHB-P-HP-PN-22 (PC 70° Reflector) [400W/500W]
CHB-P-HP-LC (PC Reflector Lens Cover) [400W/500W]

CONTROL PRE-COMMISSIONING

Default settings are indicated by *

High-End Trim/Tuning	Time Delay	Daylight Harvesting	Stand-by Light Level Setting	Stand-by Time Setting
20% - 8' height (48' dia.)	10s	*Light sensor disabled	0%	∞
50% - 20' height (40' dia.)	1min	10lux	*10%	1min
75% - 40' height (60' dia.)	*5min	30lux	30%	30min
*100% - 40' height (100' dia.)	15min	50lux	50%	*60min

High-End Trim/Tuning:

Lighting electricity usage can be reduced by 30 percent or more through high-end trim, which sets the maximum light level for each space.

High-end trim/tuning sets the appropriate target brightness for each space to the prefer light levels to minimize glare and increase comfort level.

Time Delay:

The light can be set to stay ON for any period of time between approx. 10sec and the maximum of 60 min. Any movement detected before this time elapses will re-start the timer.

Daylight Harvesting:

The chosen light response threshold can be infinitely from approx. 10-50lux.

Standby Light Level:

How much light is dimmed when no motion is detected.

Stand-by Time:

How much time after dimming will the light will shut off. Up to 60 minutes after the light has dimmed the light will shut off.

POWERED BY

SYNAPSE



Integrated Node



- Future-Proof: Integral Wireless Access Node
- Adaptable Deployment – Offline or Cloud-Connected
- Web-Browser or App Based Management
- Multiple Zones, Behaviors, Events, and Schedules
- LTE Cellular Connectivity – No Internet Required
- Professional Commissioning and After-Sales Support



Central Control Base Station



WiFi or LAN Network with browser base control interface

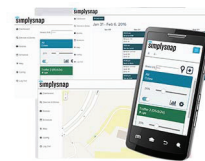

Cloud Control with Verizon 4G LTE (Optional)